

GARBAGE AND RECYCLING



(Part XI & XII)

GARBAGE AND RECYCLING



(Part XI)

*** General Requirements**

STANDARDS FOR GARBAGE AND RECYCLING CONTAINER ENCLOSURES

All enclosures used to contain garbage and recycling containers at either multi-family or commercial developments must conform to the following minimum standards:

1. Screening

All enclosures for garbage and recycling containers must be screened from public view. Screening materials include:

- a. Cyclone fencing with slats
- b. Wooden fencing
- c. Concrete block enclosure

Note: Materials other than the above-mentioned will be evaluated for approval on a case by case basis by the Site and Design Review Committee.

2. Gates

Gates must meet the following requirements:

- a. Must have a latch or some type of device that will keep the gate shut after it is closed. The device can be above or below ground.
- b. Must have a mechanism to keep them open during trash removal. The device can be above or below ground.
- c. Wheels are not required; however, the hinge must be adequate to support the weight of the gate.

3. Base Material/Flooring

The entire base dimension must meet the following requirements

- a. Must be made out of concrete. Concrete shall have a nominal thickness of 8" of 3300 PSI at 28 days. Asphalt or other material is not acceptable.
- b. Must be positively sloped to the drainage system.

GARBAGE AND RECYCLING



(Part XII)

*** Construction Details**

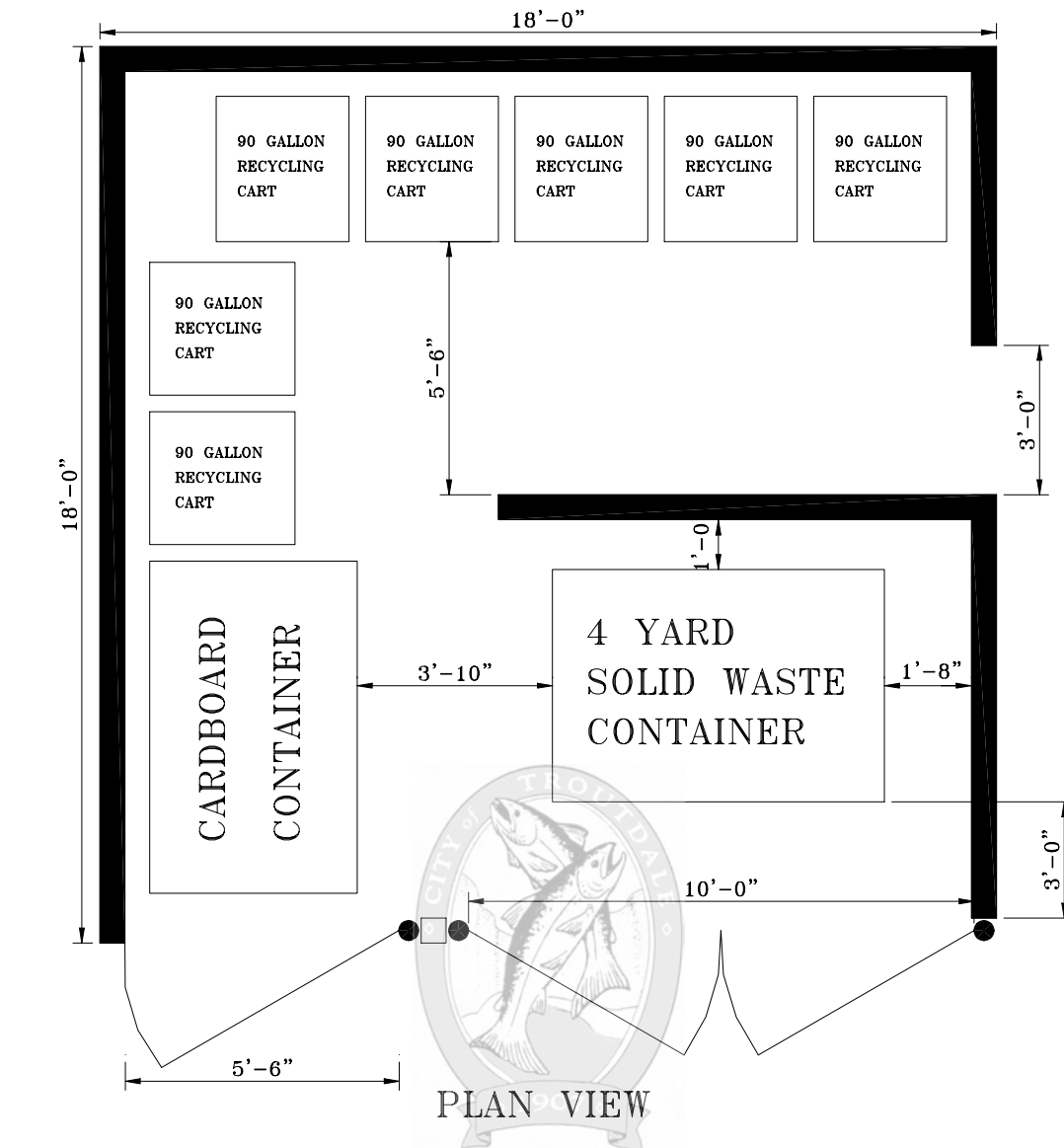

PLAN VIEW

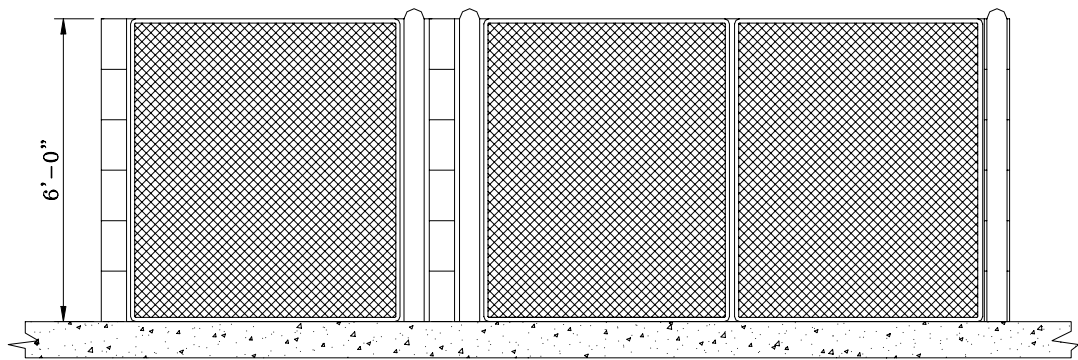

PROFILE VIEW

GENERAL NOTES

1. This can easily be converted to a commercial structure with the addition of a grease container and possibly a 6 yard solid waste container.
2. To be sized to fit into two parking spaces.

CITY OF TROUTDALE	
<i>MULTI-FAMILY SAMPLE 1</i>	
DATE: UPDATED 1997	DRAWING NO. XII - 1

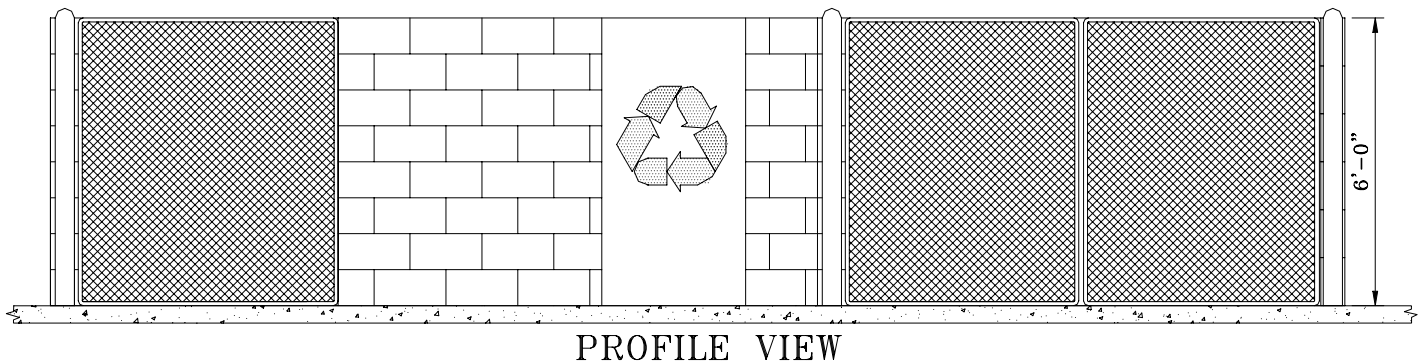
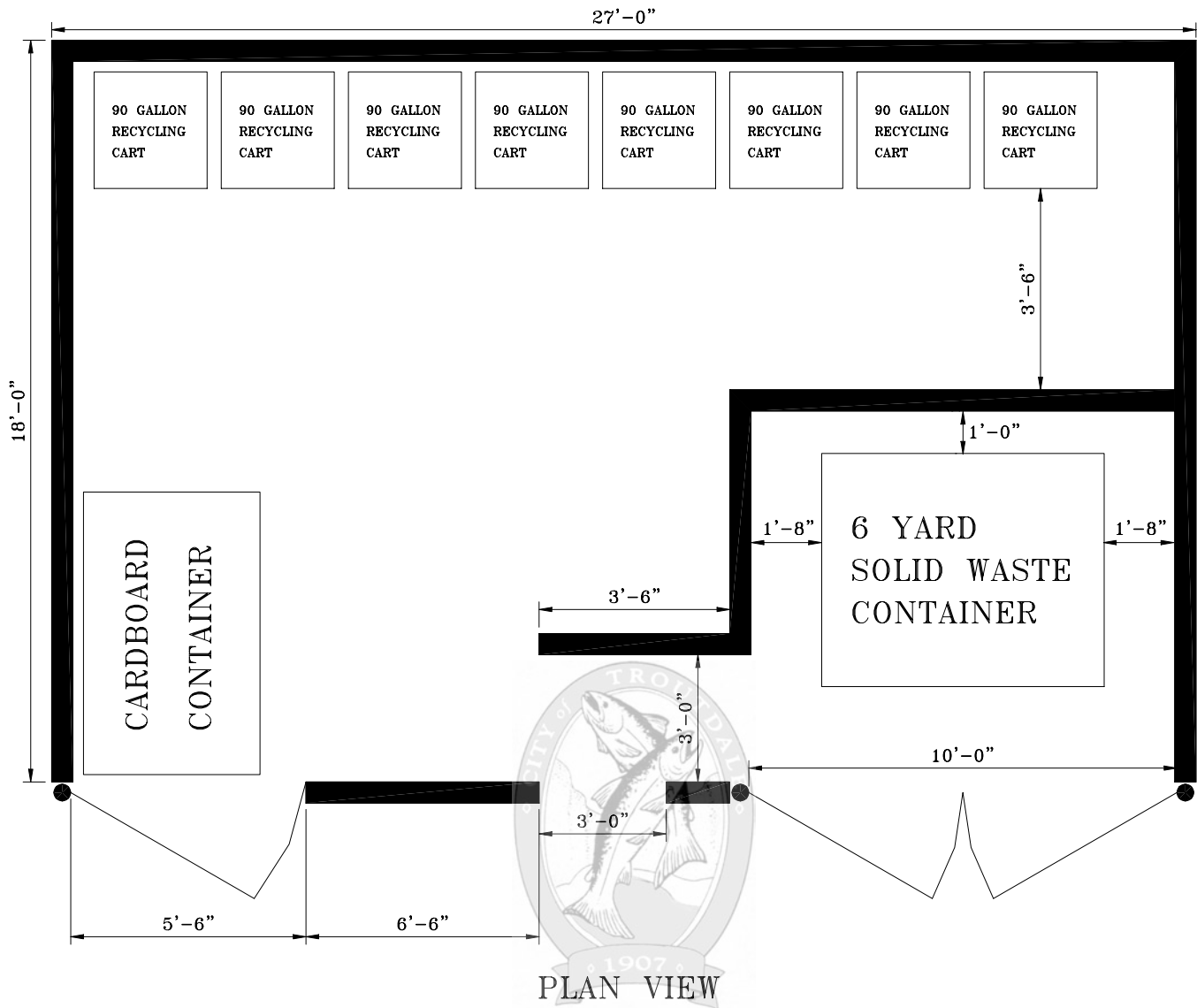

GENERAL NOTES

1. To be sized to fit exactly into three parking spaces.
2. Provides plenty of extra space.
3. Could be modified to hold an additional solid waste container.
4. This design is intended for use at a large complex.

CITY OF TROUTDALE	
<i>MULTI-FAMILY SAMPLE 2</i>	
DATE: UPDATED 1997	DRAWING NO. XII - 2

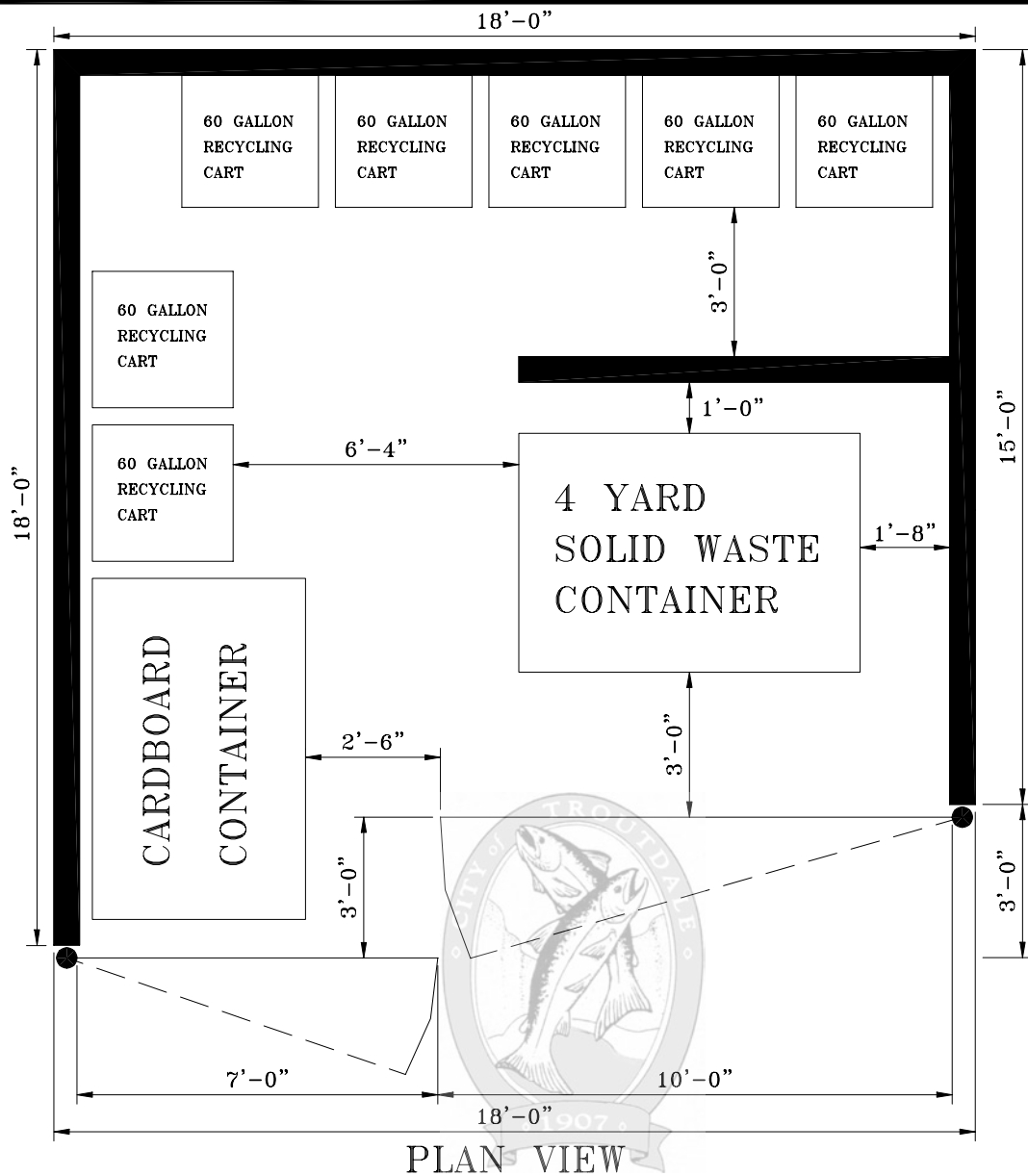

PLAN VIEW

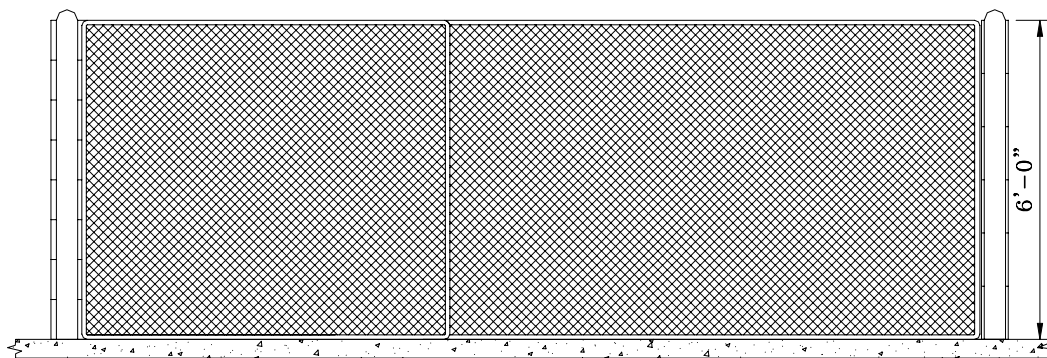

PROFILE VIEW

GENERAL NOTES

1. Plenty of room for recycling carts.
2. Easy access.
3. Simple design.
4. Can not hold larger containers.
5. There is limited clearance between the cardboard container and the dumpster gate.
6. This is a good design for a small to medium multi-family complex.

CITY OF TROUTDALE

*MULTI-FAMILY
SAMPLE 3*

DATE:
UPDATED 1997

DRAWING NO.
XII - 3

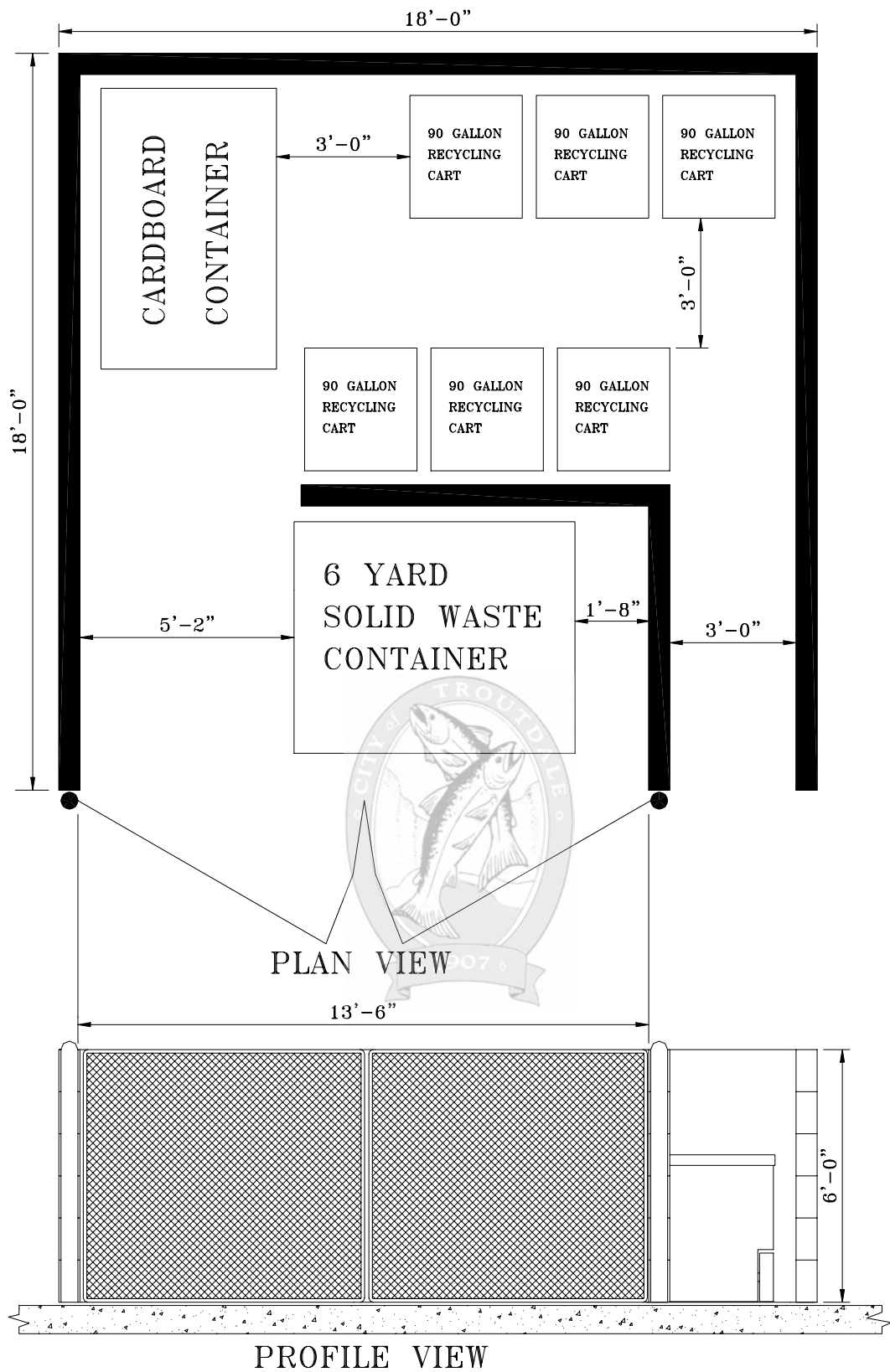

GENERAL NOTES

1. To be sized to fit two parking spaces exactly.
2. There is easy access to recycling carts while access to the solid waste container is restricted.
3. Holds a large solid waste container.
4. Very simple design (easy to construct).

CITY OF TROUTDALE

*COMMERCIAL
SAMPLE 1*

DATE:
UPDATED 1997

DRAWING NO.
XII - 4

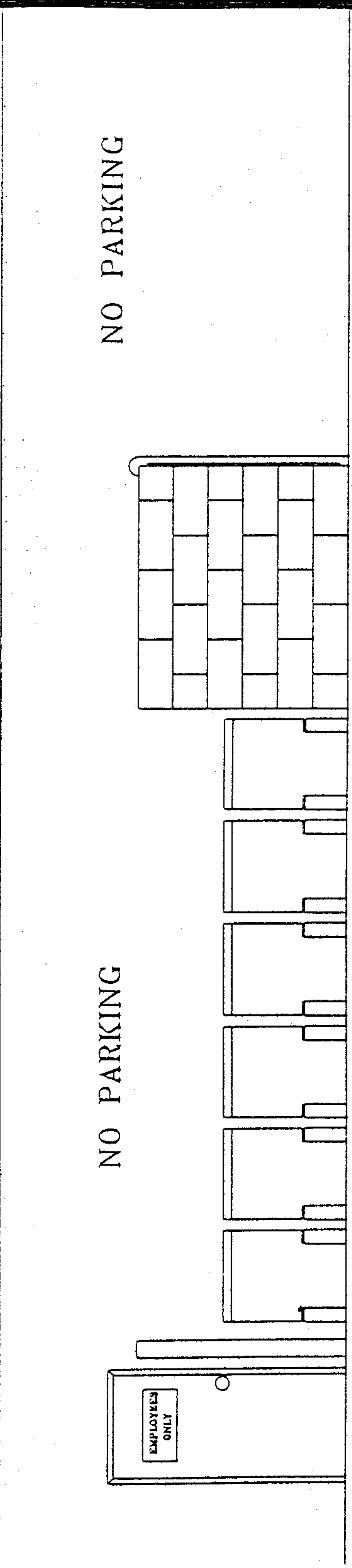
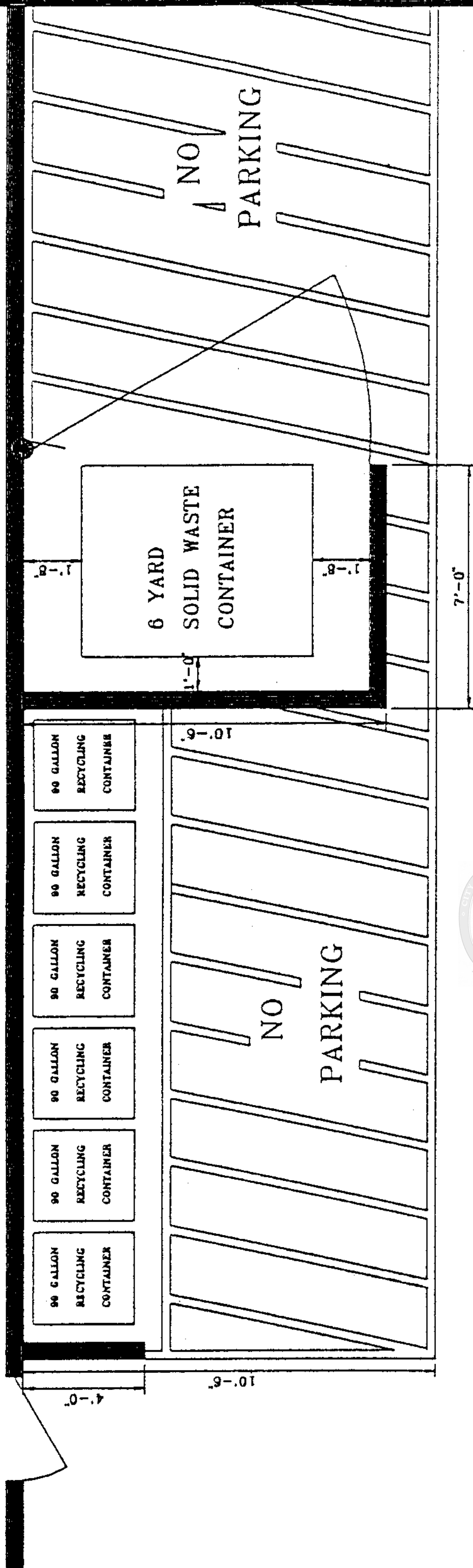

GENERAL NOTES

1. This design requires the area behind the building to be kept clean and clear for truck access.
2. Easy for driver to get in and out; takes up relatively little space.
3. This design is good for a shopping center.
4. Several enclosures could fit along the backside of a large building.

CITY OF TROUTDALE

COMMERCIAL
SAMPLE 2

DATE:
UPDATED 1997

DRAWING NO.
XII - 5

NO
PARKING

TRAVELED WAY
(TW NOT TO SCALE)

6 YARD
SOLID
WASTE
CONTAINER

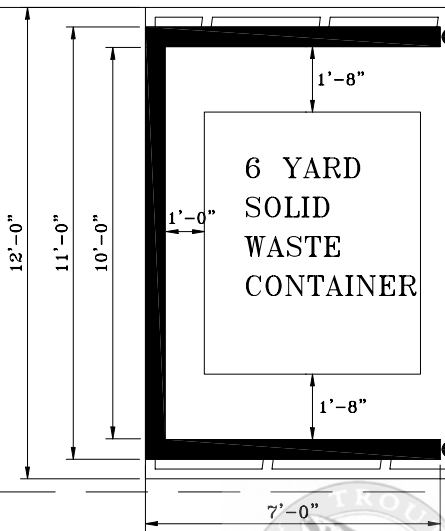

NO PARKING

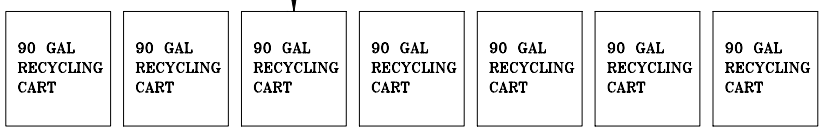

CITY OF TROUTDALE

COMMERCIAL
SAMPLE 3

GENERAL NOTES

1. This design utilizes space that is generally unused.
2. This design does not require the area behind the building to be kept clear.
3. This design works well behind a shopping center.
4. Plenty of space for recycling carts.
5. Easy for truck to get in and out.

DATE:
UPDATED 1997

DRAWING NO.
XII - 6

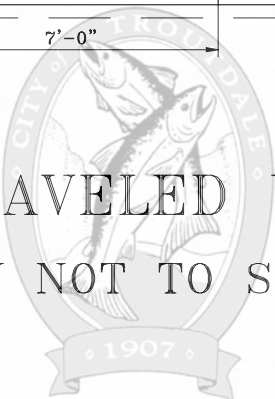

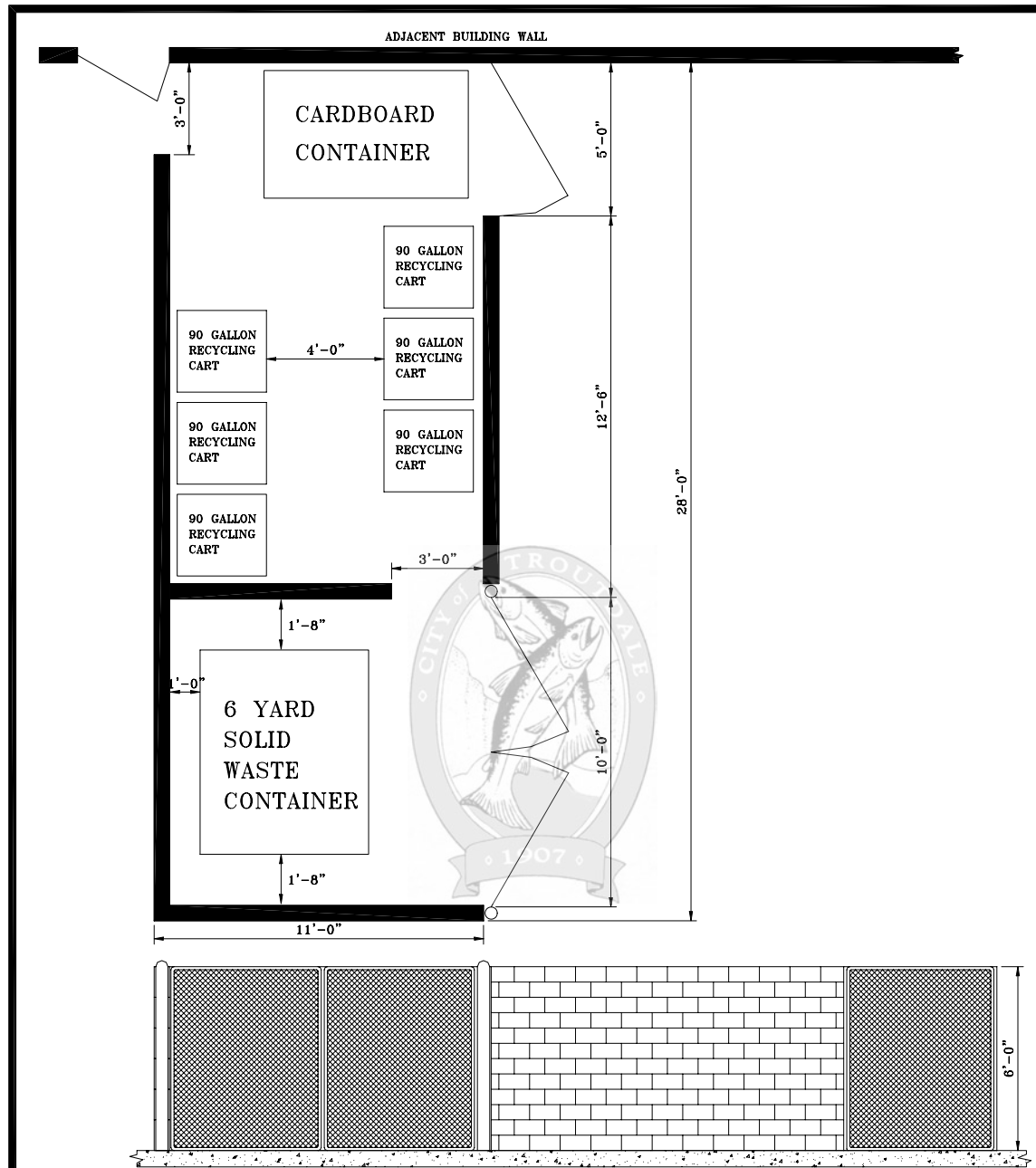

GENERAL NOTES

1. Could add a grease container, but would lose some recycling carts.
2. Could move the dumpster forward and place the grease container behind it (would require key access to the dumpster).
3. Good clear spaces; easy access.
4. Intended for small businesses especially restaurants.

CITY OF TROUTDALE	
COMMERCIAL SAMPLE 5	
DATE: UPDATED 1997	DRAWING NO. XII - 8

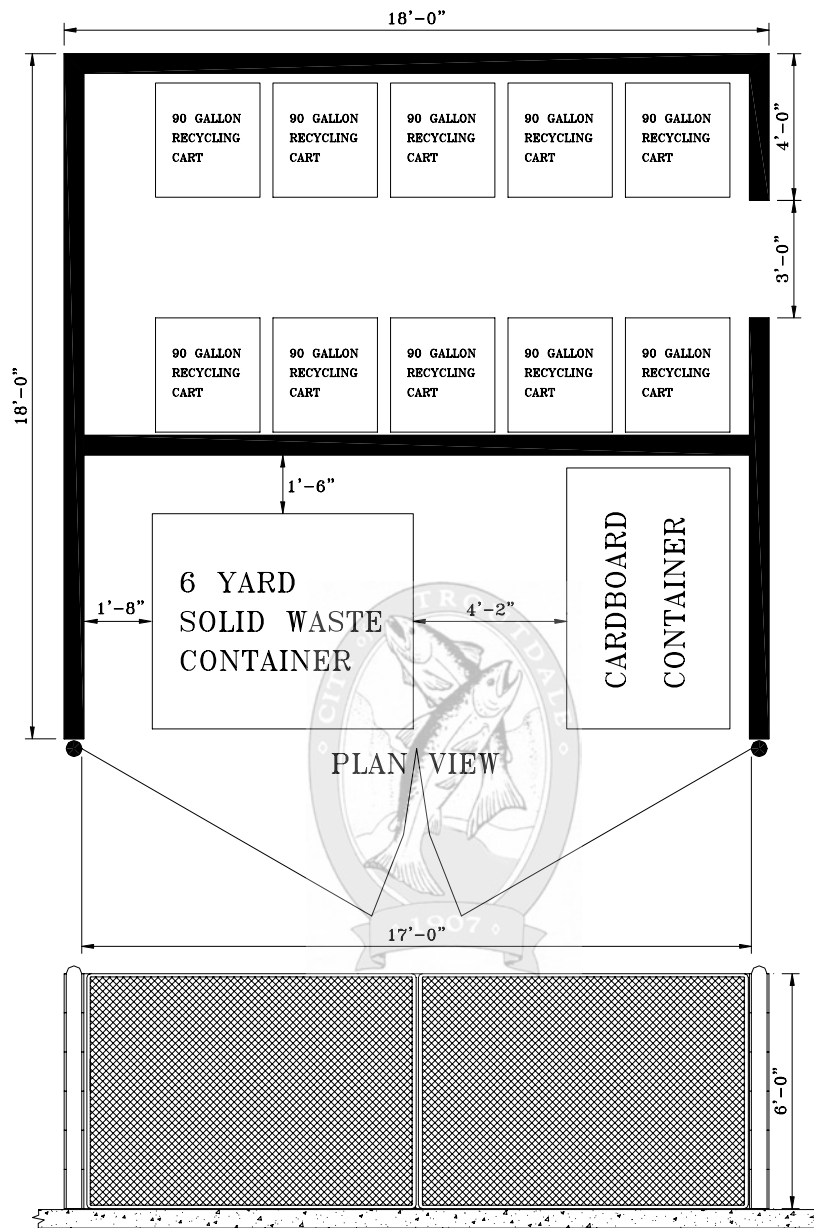

PLAN VIEW

PROFILE VIEW

GENERAL NOTES

1. To be sized to fit exactly into two parking spaces.
2. Plenty of room for recycling carts.
3. Simple design and easy to construct.
4. Easy access to recycling carts.
5. Can easily add a grease container.
6. Could eliminate middle row of recycling carts and middle wall making this enclosure suitable for a multi-family complex.
7. Holds a large solid waste container.

CITY OF TROUTDALE

*COMMERCIAL
SAMPLE 6*

DATE:

UPDATED 1997

DRAWING NO.

XII - 9